

# 18.12.2022 | Schloss für Käfig (6x)

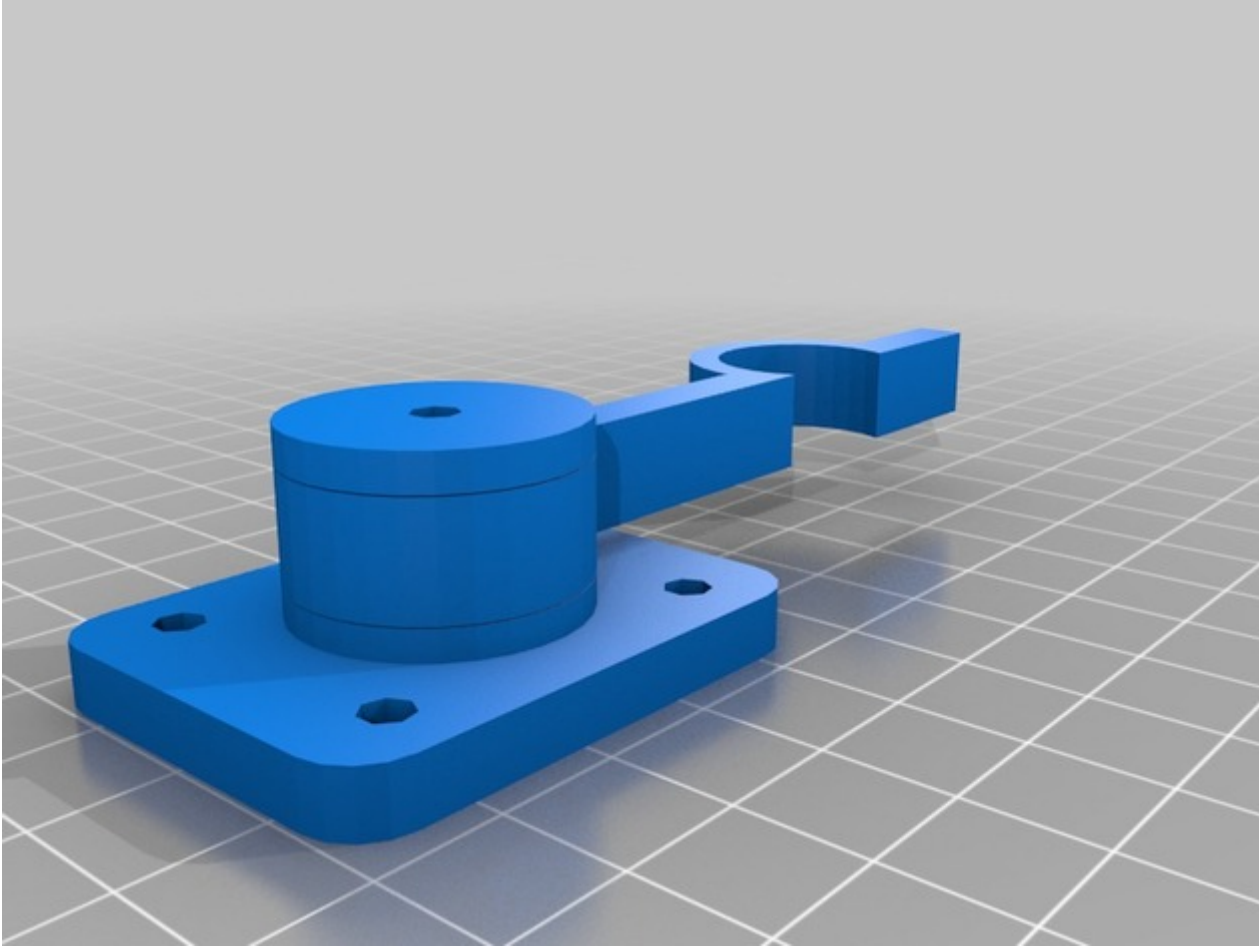

Model	<a href="https://share.jung-tobias.de/9c1NzgaTPRNAeCvH">https://share.jung-tobias.de/9c1NzgaTPRNAeCvH</a>
G-Code	
Status	Pass
Color	White
Scale	100%

Print Time		
	Base (1x)	01h 39min
	Base (6x)	09h 54min
	Top (1x) a 2	20min
	Top (6x) a 2	02h 00min
	Hook (1x)	31min
	Hook (6x)	03h 06min
	Total (1x)	02h 00min
	Total (6x)	12h 00min
Filament	<u>FIL-004</u>	
Model Page	<u><a href="https://www.thingiverse.com/thing:1351057">https://www.thingiverse.com/thing:1351057</a></u>	

---

Revision #2  
Created 19 December 2022 11:00:48 by Tobias Jung  
Updated 31 January 2025 22:28:59 by Tobias Jung